

RIDUTTORE DI PRESSIONE TIPO R160LL-08 / R4160LL-08 *PRESSURE REGULATOR TYPE R160LL-08 / R4160LL-08*

Regolatori di pressione a membrana ad alta sensibilità. Portate da 20 a 100 Nm³/h; pressioni di esercizio da 5 a 700 mbar. Pressione in ingresso massima 6 bar. Versione con interni in ottone (R160) o inox AISI 316L (R4160).

Peso: 1 Kg

Diaphragm pressure regulators with high performance. Flow 20 to 100 Nm³/h; working pressures from 5 to 700 mbar. Maximum inlet pressure 6 bar. Internal parts in brass (R160) or in stainless steel AISI316L (R4160).

Weight: 1 Kg



Pressione di ingresso massima 6 bar - *Maximum inlet pressure 6 bar*

Materiali di costruzione R160 - *Materials of construction R160:*

- | | |
|---------------------------------------|---|
| - Corpo – <i>Body:</i> | Alluminio - <i>Aluminium</i> |
| - Campana – <i>Bonnet:</i> | Acciaio Inox AISI316L – <i>Stainless steel AISI316L</i> |
| - Parti interne – <i>Inner parts:</i> | Ottone - <i>Brass</i> |
| - Membrana – <i>Diaphragm:</i> | NBR telato – <i>NBR with cotton</i> |

Materiali di costruzione R4160 - *Materials of construction R4160:*

- | | |
|---------------------------------------|---|
| - Corpo – <i>Body:</i> | Alluminio - <i>Aluminium</i> |
| - Campana – <i>Bonnet:</i> | Acciaio Inox AISI316L – <i>Stainless steel AISI316L</i> |
| - Parti interne – <i>Inner parts:</i> | Acciaio Inox AISI316L – <i>Stainless steel AISI316L</i> |
| - Membrana – <i>Diaphragm:</i> | NBR telato – <i>NBR with cotton</i> |

Temperatura di esercizio – *Working temperature:*

Da -20°C a +60°C – *From -20°C to +60°C*

Disegni relativi al regolatore R160 con dimensioni di ingombro:
Drawings of regulator R160 with overall dimensions:

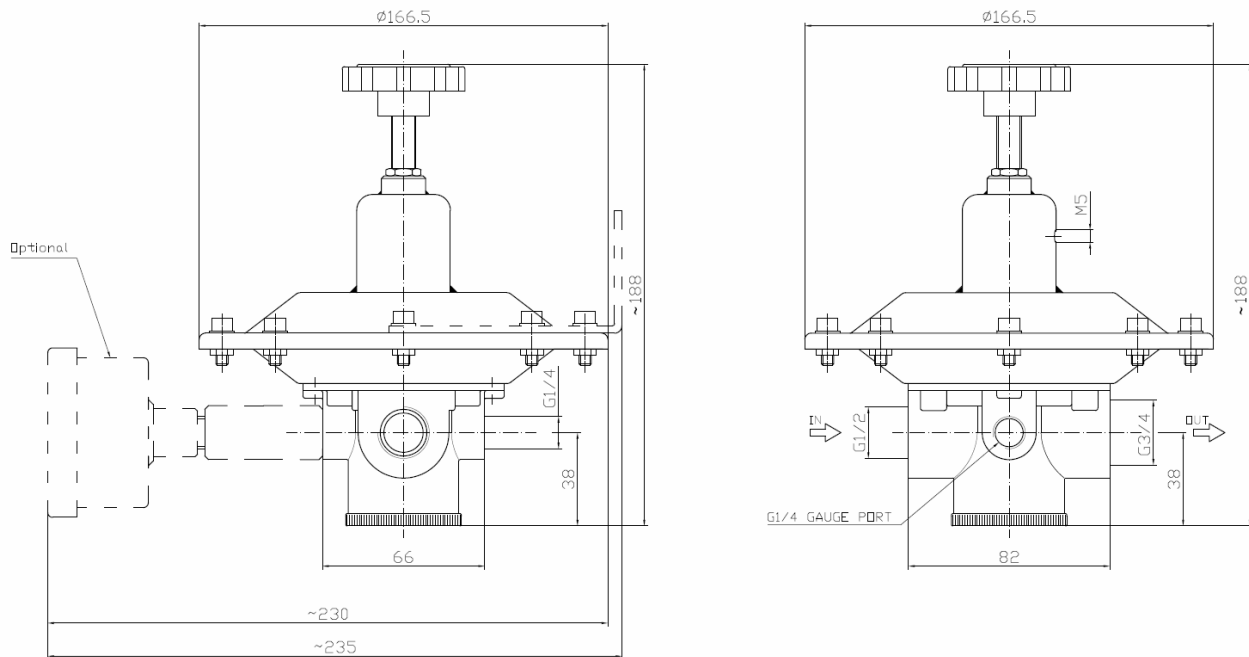

R160 A-B-C

MODELLI E PRESTAZIONI
MODELS AND PERFORMANCES

Modello <i>Model</i>	P_e P_{in}	P_u P_{out}	portata max max flow	Attacchi entrata <i>Inlet</i> connections	Attacchi uscita <i>Outlet</i> connections	Tipo di gas <i>Kind of</i> fluid	Codice di vendita <i>Sale Codes</i>
	[bar]	[mbar]	[Nm ³ /h]				
R 160 A R 4160 A	6	5-45	50	1/2" BSP Femmina <i>female</i>	3/4" BSP Femmina <i>female</i>	Da indicare <i>To specify</i>	160#P0A0N0xxxxx 4160#P0A0N0xxxxx
R 160 B R 4160 B	6	20-200	90				160#P0A0P0xxxxx 4160#P0A0P0xxxxx
R 160 C R 4160 C	6	150-700	110				160#P0A0Q0xxxxx 4160#P0A0Q0xxxxx

ESECUZIONI SPECIALI	SPECIAL EXECUTIONS
<ul style="list-style-type: none"> ○ Attacchi entrata e uscita diversi da standard ○ Marchiatura speciale ○ Membrana in PTFE ○ Guarnizioni speciali ○ Flange 	<ul style="list-style-type: none"> ○ <i>Non standard in / outlet connections</i> ○ <i>Special mark on body</i> ○ <i>Diaphragm of PTFE</i> ○ <i>Non standard gaskets</i> ○ <i>Flanges</i>



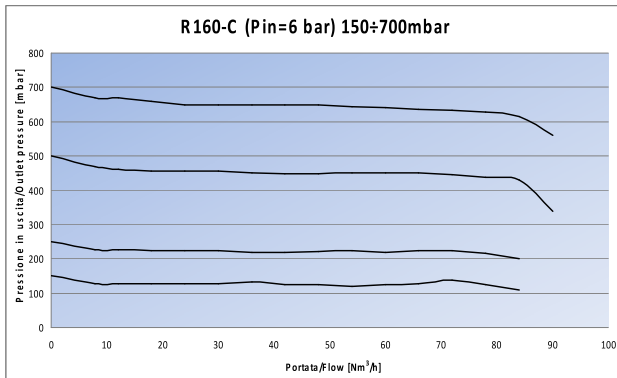
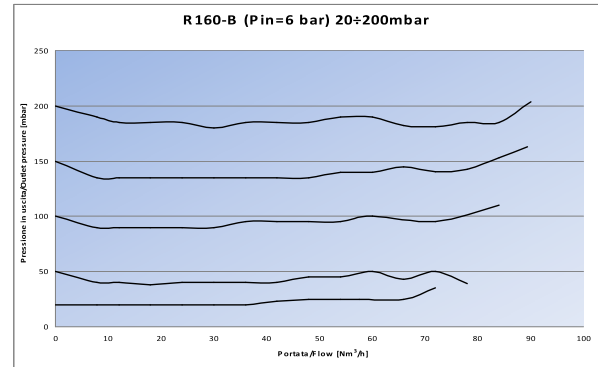
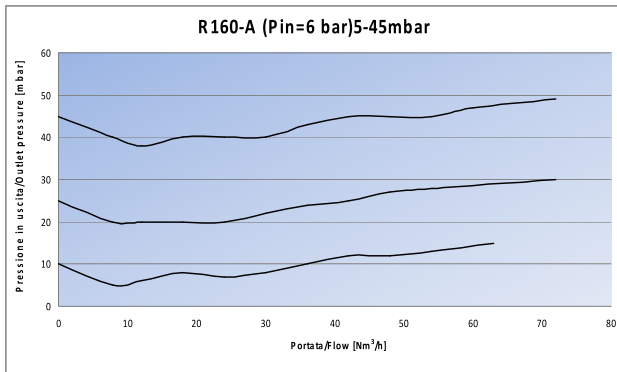

Riduttore INOX AISI316L: Vedi catalogo (R3160)
Stainless steel regulator AISI316L: see catalogue (R3160)

Curve di portata ricavate con prove eseguite con Azoto (N₂), scarico libero e ingresso a 3 e 6 bar:
low characteristics obtained by free exhaust test with Nitrogen (N₂) with 3 and 6 bar inlet pressure:



PARTI DI RICAMBIO SPARE PARTS KIT

Tipo Type	Kit ricambi Spare parts Kit	Tipo di gas Kind of fluid	Codice Code
R160A	Membrana, otturatore, guarnizioni, filtri <i>Diaphragm, main valve, gaskets, filters</i>	Da indicare <i>To specify</i>	K160#01A001xxxxx
R160B			K160#01A001xxxxx
R160C			K160#01A002xxxxx
R4160A			K160#02A001xxxxx
R4160B			K160#02A001xxxxx
R4160C			K160#02A002xxxxx

Accessori Optionals	Riduttore Regulator	Scala manometro Gauge range	Codice Code		Peso Weight
Manometro $\varnothing 63$ attacco posteriore compreso raccordo. <i>Gauge $\varnothing 63$ back connection with fitting.</i>	R160A	0-60 mbar	M62201		250 g
	R160B	0-300 mbar	M62202		
	R160C	0-1 bar	M62203		
Manometro Inox $\varnothing 63$ attacco posteriore compreso raccordo. <i>Stainless steel Gauge $\varnothing 63$ back connection with fitting.</i>	R4160A	0-60 mbar	M63301		350 g
	R4160B	0-300 mbar	M63302		
	R4160C	0-1 bar	M63303		
		Codice Code			
Staffa Bracket	R160 A-B-C R4160 A-B-C		M11203		400 g
Scarico su campana convogliato G1/8 Maschio <i>Venting on bonnet 1/8" BSP Male</i>	R160 A-B-C R4160 A-B-C				15 g

Ci riserviamo di apportare modifiche ai nostri prodotti senza preavviso
We reserve to modify our production without previous communication